

Water Bottle for Birds

2 plastic bottles required

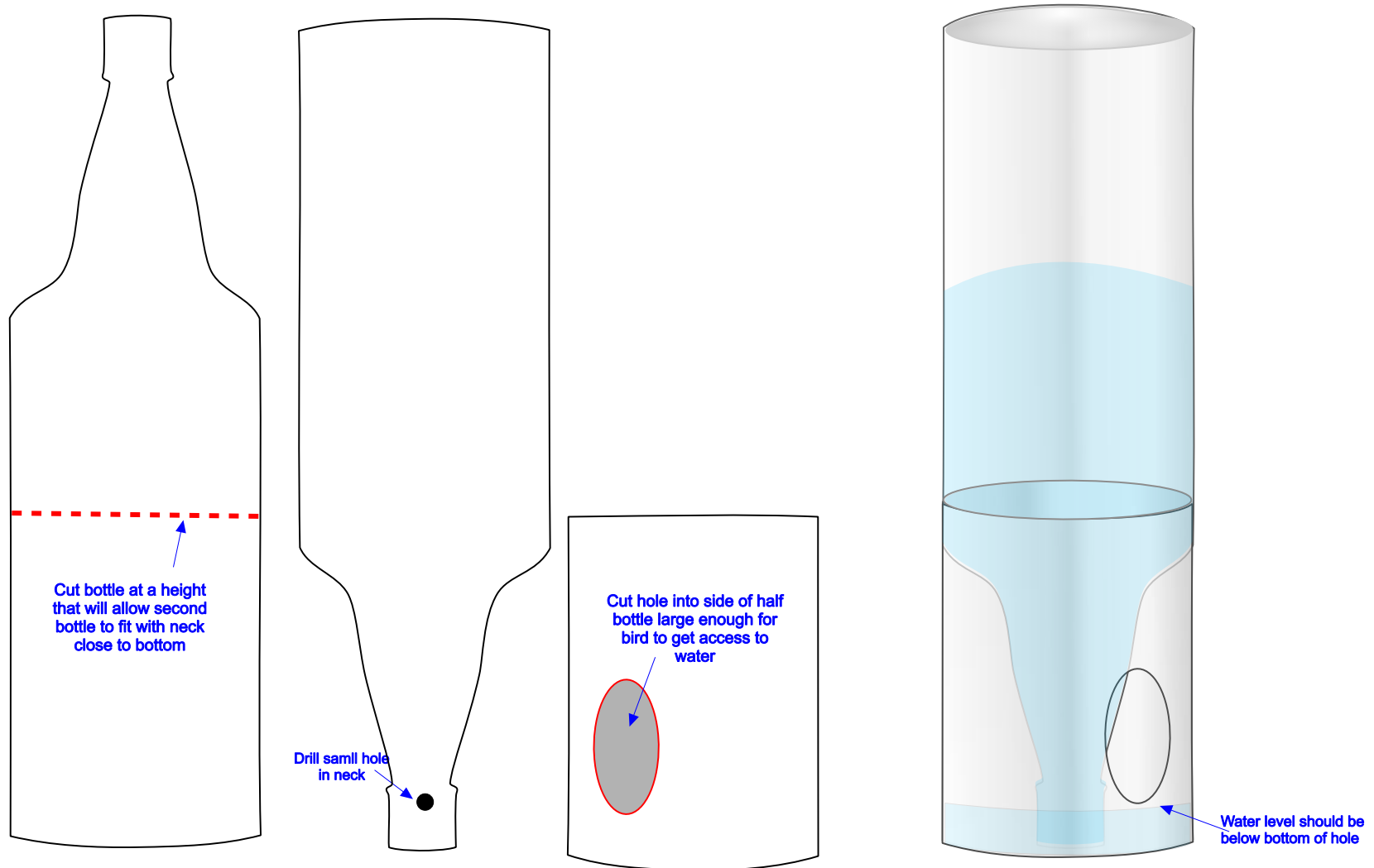

Canberra Indian Myna Action Group Inc

Constructing the PeeGees Trap – Tips

Aspects of trap building – some things to get right

Over the past few months we have seen traps made by groups that we consider need some adjustment. We put that down to the design plans for our PeeGees trap on our website not being detailed enough. We applaud the inventiveness of groups in refining trap designs aspects, but if making the Pee Gees trap (or the variations of it) there are a few aspects that it is best to bear in mind.

Firstly, **the door to the larger containment chamber** should overlap the opening by one mesh square all the way around. Also don't make the door opening any bigger than 6 mesh squares high by 5 mesh squares wide. Any bigger makes it more difficult to have a close fitting door – mynas will easily push through any slight gap.

Secondly, the **one-way valve** should narrow down at the top. You can do this by tying the wire into the second mesh square from the sides at the top. See photo.

Thirdly, **the tunnel in the feeding chamber** should be 3 mesh squares wide on the outside, narrowing down to 2 mesh squares on the inside. This makes it harder for mynas to turn around in the tunnel to get out, and when they are inside the feeding chamber it is harder for them to see that the entrance tunnel is also an exit tunnel.

