

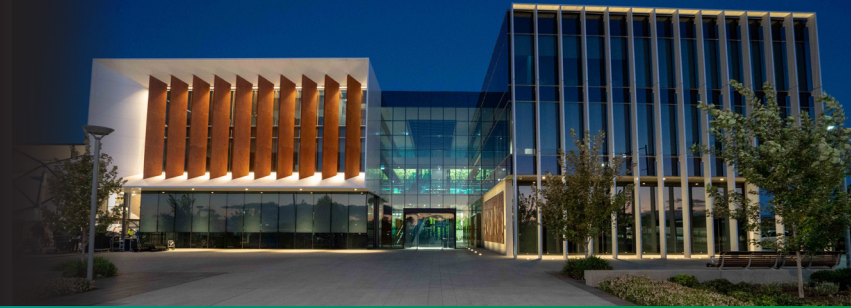

camden council



Expressions of interest

2022 EXPRESSIONS OF INTEREST FOR REGULAR HALL HIRE

Applications in the 2022 Expression of Interest for Regular Hall hire are now open.

Interested parties are encouraged to lodge an expression of interest application for use of Council's community facilities for the 2022 calendar year.

Applications close 5pm Friday 8 October 2021.

Regular hall hire under Camden Council is defined as "hirers who, in a single booking, hire the same facility on a minimum of 10 occasions in a calendar year that form a consecutive pattern."

Any businesses, groups or organisations seeking information on Regular Hall hire, or the 2022 Expression of Interest for Regular Hall hire are encouraged to contact Council for more information.

For further information, please contact Council's Sports and Community Facilities Team on 4654 7777. Applications must be submitted via email to recreationofficers@camden.nsw.gov.au

- Birriwa Reserve Community Centre
- Catherine Fields Community Centre
- Catherine Park Community Centre
- Currans Hill Community Centre
- Emerald Hills Community Centre
8am - 5pm Monday to Friday only
- Gregory Hills Community Centre
- Harrington Park Community Centre
- Jack Nash Clubroom
- Lakeside Rooms Oran Park
limited availability
- Narellan Child Family and Community Centre
- Narellan Library Meeting Rooms
limited availability
- Sandown Rooms Oran Park
- Spring Farm Community Centre



70 Central Ave, Oran Park 2570



PO Box 183, Camden 2570



4654 7777



4654 7829



mail@camden.nsw.gov.au



camden.nsw.gov.au